



LOGISTICS[®]
PROPERTY
CO

SOUTHERN STAR LOGISTICS PARK

SE Corner Of US-67 & Railport Parkway, Midlothian, TX 76065



BUILDING/SITE INFORMATION

- 185' Truck Courts
- 570' Building Depth
- Expandable up to 1msf
- 60' Speed Bays
- US-67 Access
- Established Park Setting
- Spec Office
- 548,340 sf
- 96 dock doors
- 136 trailer parking spots (expandable to 204)
- 216 car parking spots
- ESFR fire suppression system

CBRE

2100 McKinney Ave
Suite 700
Dallas, TX 75201

Kacy Jones

+1 214 979 6151 • kacy.jones@cbre.com

Steve Koldyke

+1 214 979 6381 • steve.koldyke@cbre.com

Brian Gilchrist

+1 214 979 6394 • brian.gilchrist@cbre.com

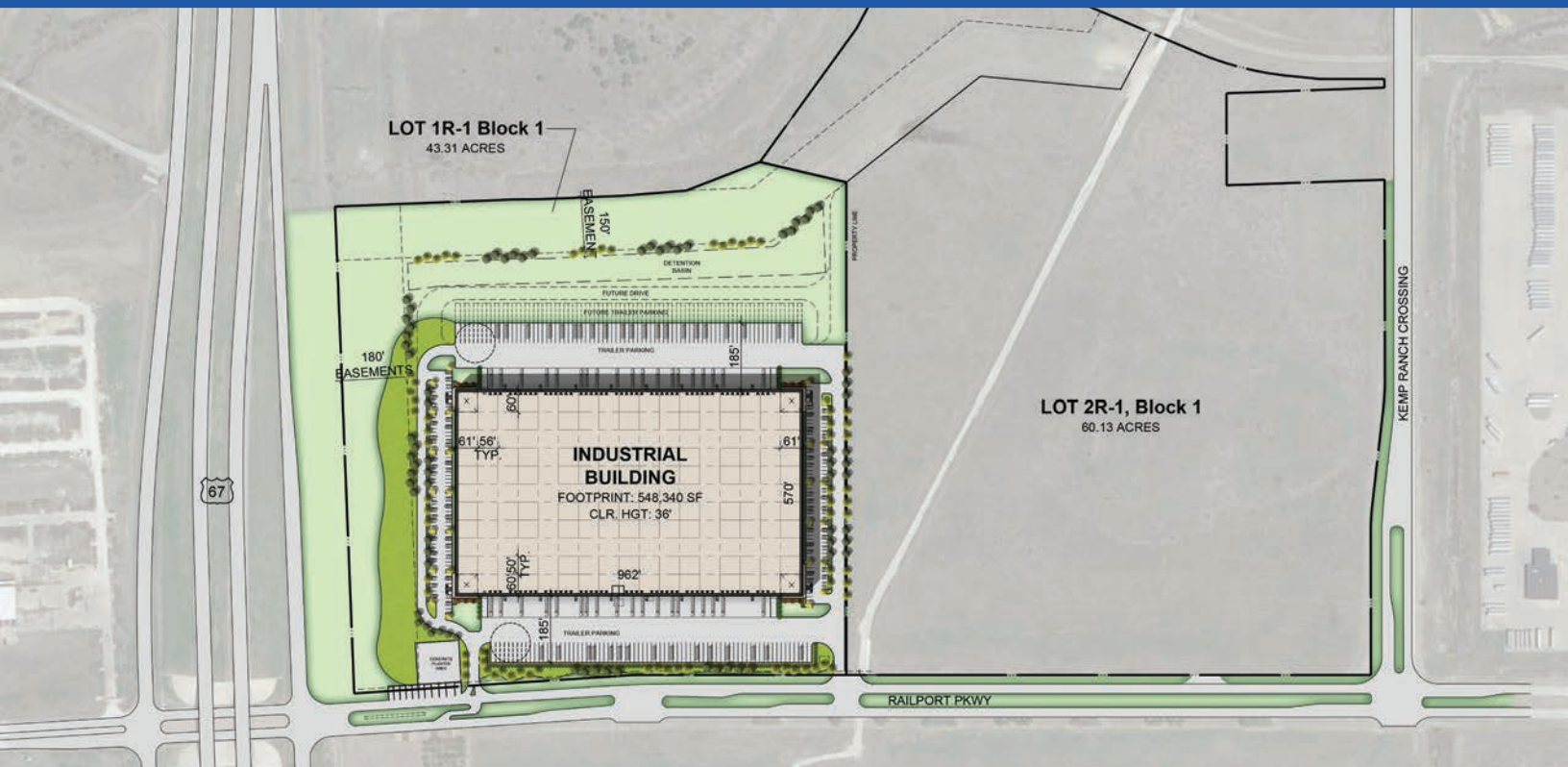

HIGHLIGHTS

Logistical Advantages

- US-67 Access
- Proximity to US-287
- Dual-Rail Service

Park Incentives

- Park Setting
- City of Midlothian Economic Incentives

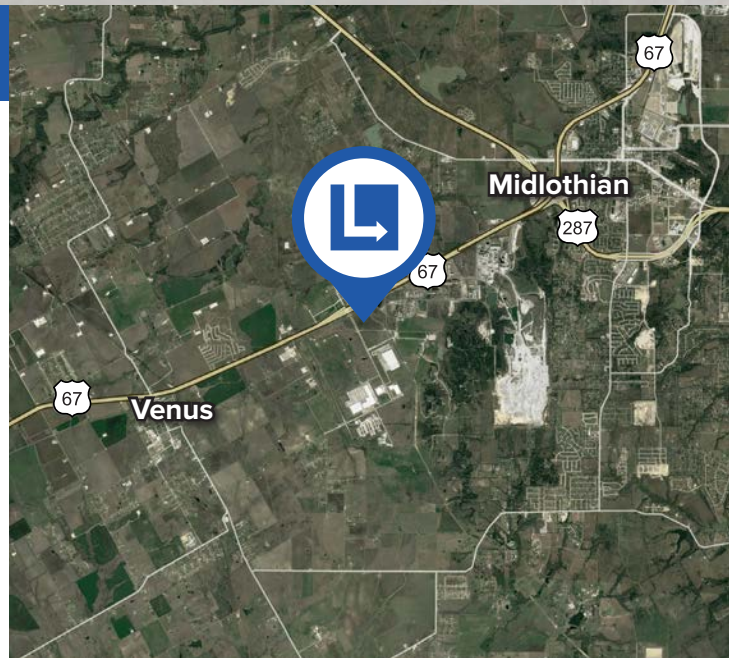

© 2021 CBRE, Inc. All rights reserved. This information has been obtained from sources believed reliable but has not been verified for accuracy or completeness. You should conduct a careful, independent investigation of the property and verify all information. Any reliance on this information is solely at your own risk. CBRE and the CBRE logo are service marks of CBRE, Inc. All other marks displayed on this document are the property of their respective owners, and the use of such logos does not imply any affiliation with or endorsement of CBRE.

CBRE

2100 McKinney Ave
Suite 700
Dallas, TX 75201

Kacy Jones

+1 214 979 6151 • kacy.jones@cbre.com

Steve Koldyke

+1 214 979 6381 • steve.koldyke@cbre.com

Brian Gilchrist

+1 214 979 6394 • brian.gilchrist@cbre.com